

# ASSEMBLY AND INSTALLATION INSTRUCTIONS

W0148

**WARNING:** TO AVOID RISK OF ELECTRICAL SHOCK, BE SURE TO SHUT OFF POWER WHILE INSTALLING OR SERVICING THIS FIXTURE.

**NOTES:** 1. Before installing, consult local electrical codes for wiring and grounding requirements.  
2. Read and save these instructions.

## Hardware Package (included):

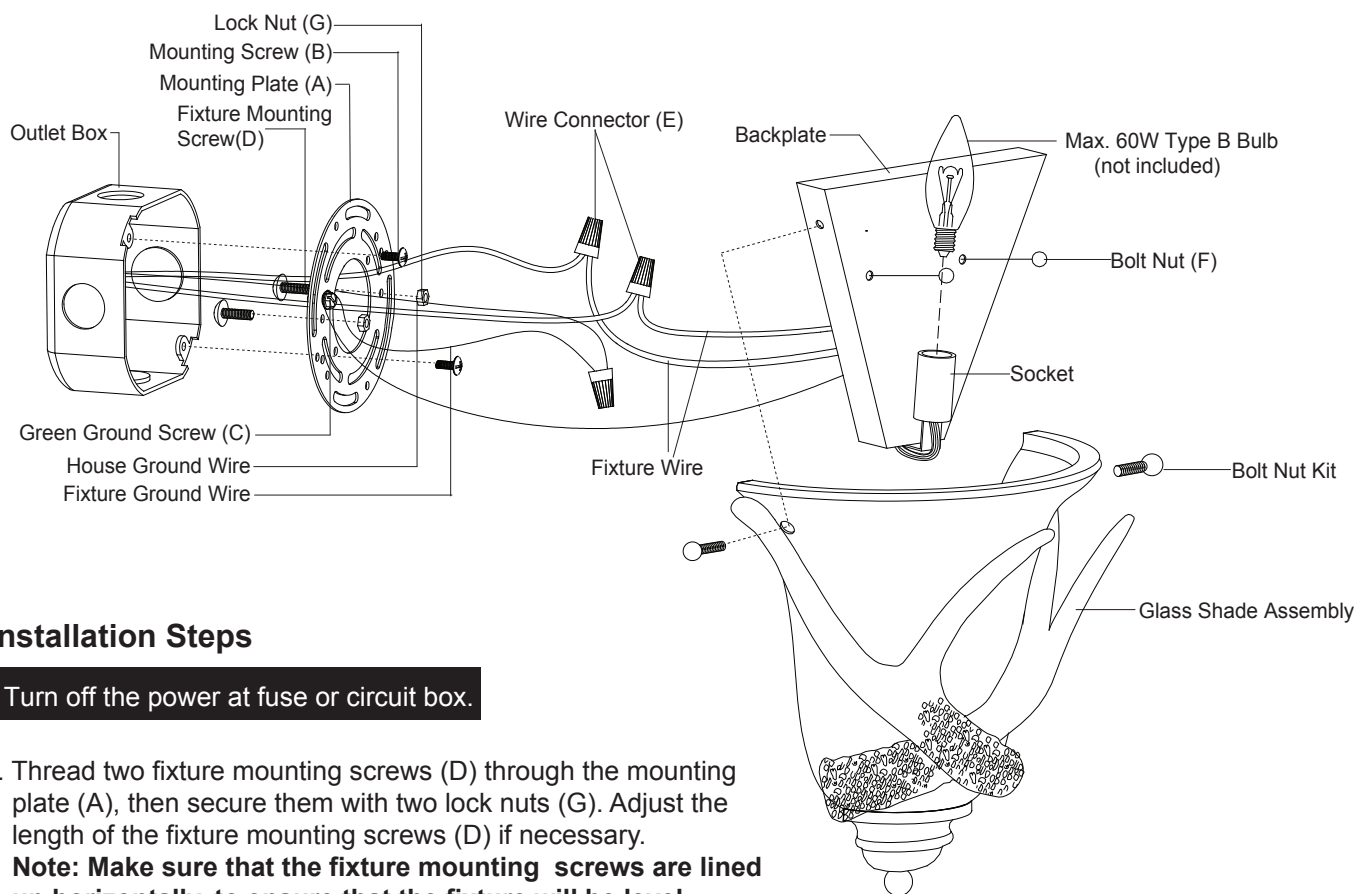
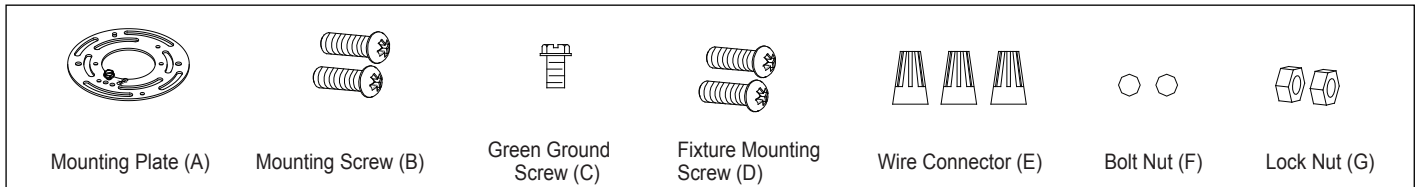

## Installation Steps

Turn off the power at fuse or circuit box.

1. Thread two fixture mounting screws (D) through the mounting plate (A), then secure them with two lock nuts (G). Adjust the length of the fixture mounting screws (D) if necessary.  
**Note: Make sure that the fixture mounting screws are lined up horizontally, to ensure that the fixture will be level.**
2. Attach the mounting plate (A) to the outlet box by using two mounting screws (B).
3. Pull out the source wires from the outlet box. Make wire connections using wire connectors (E) as follows:  
---Connect the hot wire (black insulation) from the fixture to the black wire from the power source.  
---Connect the neutral wire (white insulation) from the fixture to the white wire from the power source.  
---Attach the fixture ground wire (bare wire) to the mounting plate (A) with the green ground screw, then connect it to the house grounding wire with the wire connector (E).  
Carefully put the wires back into the outlet box.
4. Attach the backplate to the mounting plate (A) by inserting two fixture mounting screws (D), then secure it with two bolt nuts (F).

5. Install bulb (not included). See relamping label at socket area or packaging for maximum wattage allowed .
6. Attach the glass shade assembly to backplate, secure it with bolt nut kits.

**Turn on the power at fuse or circuit box.**

The following parts are available for reorder if damaged or missing.

**Spare Parts List:**

Mounting Plate (A)      Mounting Screw (B)      Green Ground Screw (C)

Fixture Mounting Screw (D)      Wire Connector (E)      Bolt Nut (F)      Lock Nut (G)

Assembly Kit 5267MM (1 SET)

Glass Shade 9693CR

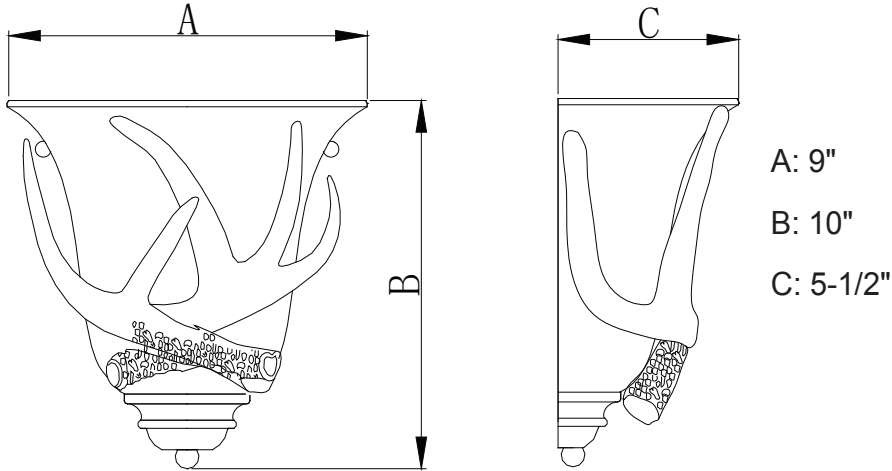

### 1 Year Warranty

Vaxcel warrants all of our products against defects in workmanship and finishes for one year following the date of shipment.

*Exclusions: This warranty does not include the failure of products from extreme acts of nature; environmental conditions not suited for the products intended use; operation in temperatures outside of the range specified in the instruction manual; usage with improper power supply, power surges or dips. For coastal locations, some corrosion is considered normal for the environment.*

*Vaxcel reserves the right to repair, replace or issue a credit for any properly installed product, provided it is returned per RMA instruction. This warranty is limited to the cost of the product only and does not extend to transportation, installation or replacement costs.*

How can warranty service be obtained?  
[info@vaxcel.com](mailto:info@vaxcel.com)  
 1-800-482-9235